



These instructions and the images herein are proprietary. Any unauthorized reproduction is prohibited.

GW-TB-DF-N

Installation Notes for GoWesty Throttle Valve Housing

INSTALLATION NOTES:

This new GoWesty Throttle Valve Housing aka Throttle Body is designed to work with the factory tension spring. You WILL need this spring attached in the factory location between the intake plenum and the throttle valve housing lever in order for the housing to work properly. The spring attachment point on the housing lever is indicated in the diagram below with a red arrow.

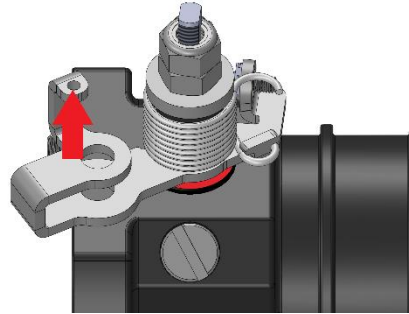

NOTE: If a stiffer throttle pedal is desired, the longer hook on the factory tension spring can be shortened with a pair of needle nose pliers. Bend the spring a little at a time until the desired throttle stiffness is met.



FACTORY CRUISE CONTROL NOTES:

If, and ONLY if, your Vanagon has factory cruise control, you will need to remove the cruise control fitting from your old throttle valve housing for use on your new housing.

Remove the cruise lever (ball fitting) from the old throttle valve housing. After removing the cruise lever, reinstall the nut and washer on the old housing so the original is complete.

Install the cruise lever on your new throttle valve housing by removing the top nylock nut from your GoWesty housing. **IMPORTANT: Use two, 13mm open end wrenches. One wrench should be used to hold the lower nut MOTIONLESS while the other wrench is used to remove and reinstall the upper nut from the throttle valve housing.** The cruise lever should be installed between the two nuts. Be sure not to turn the lower nut **at all** during this process. Pay special attention to the orientation of the cruise lever shown in the photo.

ADDITIONAL NOTE ON IDLE ADJUSTMENT:

- If turning the idle air adjustment screw all the way out still does not allow your engine to idle high enough; your idle control system is not working properly. Please read the "Idle Control System" article online (GW library) for troubleshooting assistance.
- NOTE: DO NOT adjust the small allen set screw on the throttle lever. This screw sets the throttle plate closed position and is pre-set at GoWesty.

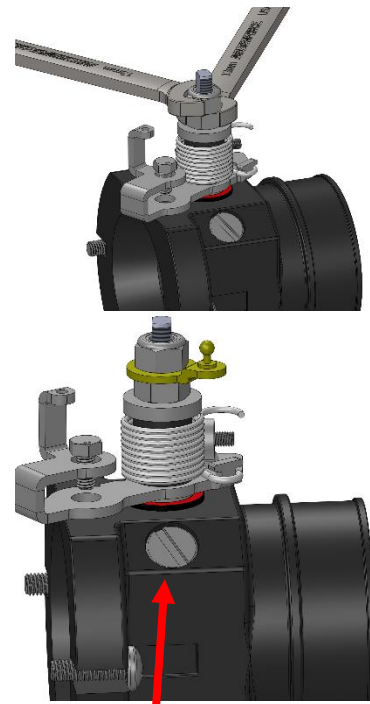

IDLE
ADJUSTMENT
SCREW



These instructions and the images herein are proprietary. Any unauthorized reproduction is prohibited.

GW-TB-DF-N

1.9L Retrofit Notes for GoWesty Throttle Valve Housing

1.9L RETROFIT

TWO MICRO-SWITCH TPS

The GoWesty Throttle Valve Housing is a direct fit for all 2.1L housings and 1.9L housings that have 1 micro-switch located under the housing. This housing is NOT a direct replacement for 1.9L throttle valve housings with the two micro-switches on top of the housing; modification to the EFI wiring harness is necessary for that application.

If, and ONLY if, you had a 1.9L throttle valve housing with TWO micro-switches mounted on the top of your original housing you will need to re-wire your throttle position switch connections according to the diagram below. NOTE: The factory-style two-pin female connector, seal, and terminal kit (GW-2PIN-BOSCH) shown below is sold separately.

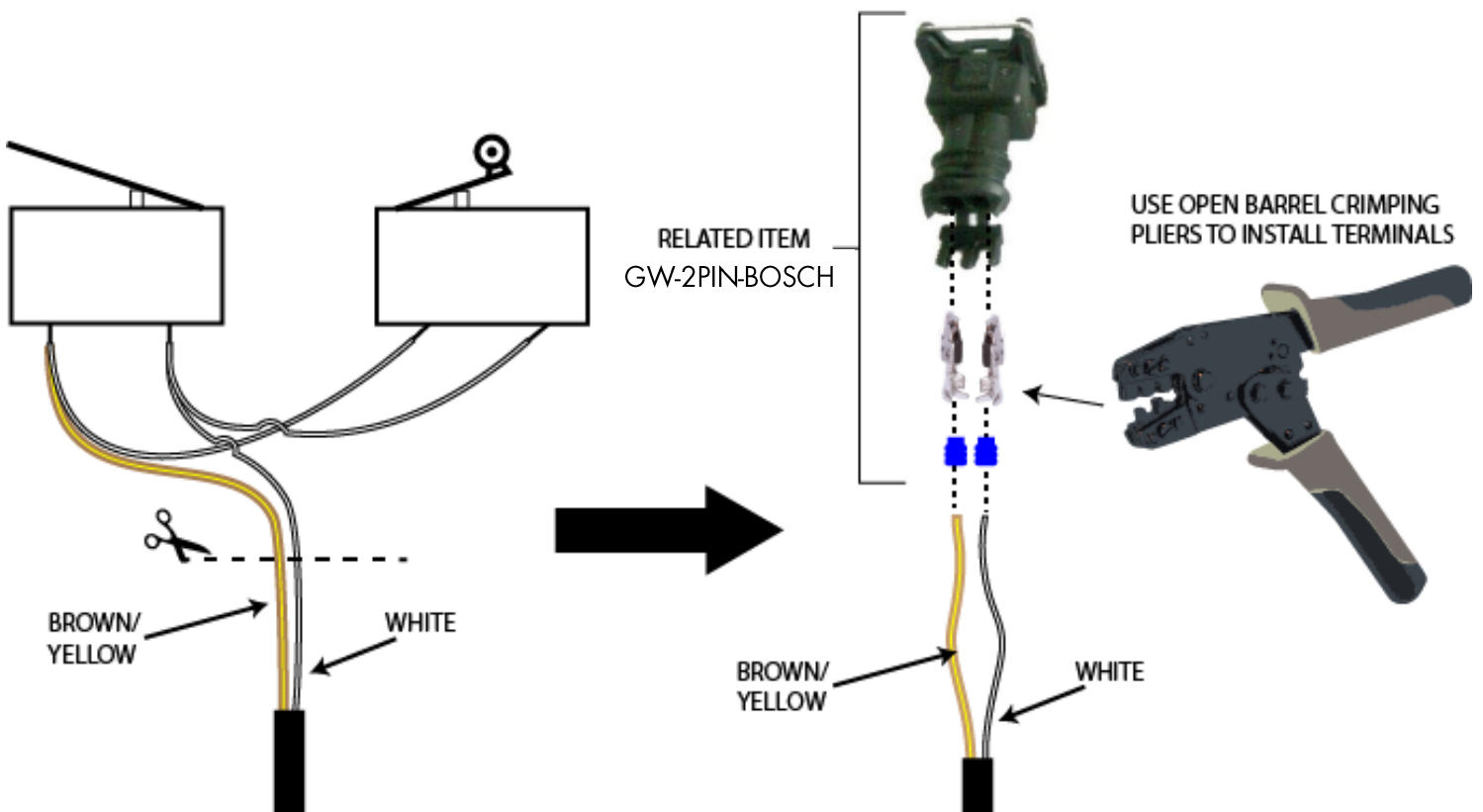

DIGIJET VACUUM LINES (83-85 1.9L USA Vanagon)

The vacuum port on our housing is used on all Vanagons for the fuel tank vapor control system, and for the *vacuum advance* side of the distributor diaphragm used with Digijet. Connect the vacuum advance side of the distributor diaphragm to the vacuum port on the new throttle valve housing.

The *vacuum retard* port is *manifold vacuum*. Simply T off of the vacuum line that runs to the fuel pressure regulator and plumb that to the vacuum retard port on the distributor diaphragm.

